



L00200BX

Boxer 200W

■ SPECIFICATIONS

Identity No.	L00200BX
Capacity	200W
Lamp Bulb Voltage	70V
Par Lens	Ø112mm (4-3/8 in.)
Weight (without barndoor)	1.2 kg
Lamp Type	HMI 200W SE 5600K
Lamp Holder	GZY9.5
Stirrup	Ø16mm (5/8 in.) Socket
Class / IP Rating	1 / 20
Max. Surface Temp.	170 °C
Max. Ambient Temp.	45 °C
Min. Distance to Illuminated Object	3.0 m
Min. Distance to Flammable Object	0.5 m
Operating Range	45° - 0° - 45°

■ DIMENSIONS (mm)

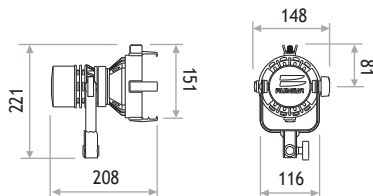

■ PHOTOMETRIC DATA

		Distance	2m	4m	6m
200W	Spot (9°)	Lux	149430	37358	16603
		Beam Ø	0.31 m	0.63 m	0.94 m
Medium Flood (10° x 20°)	Lux	24443	6111	2716	
	Beam Ø	0.35 x 0.71 m	0.70 x 1.41 m	1.05 x 2.12 m	
Wide Flood (20° x 40°)	Lux	7625	1906	847	
	Beam Ø	0.71 x 1.46 m	1.41 x 2.91 m	2.12 x 4.37 m	
Super Wide Flood (40°)	Lux	2955	739	328	
	Beam Ø	1.46 m	2.91 m	4.37 m	
Frosted Super Flood (32°)	Lux	2273	568	253	
	Beam Ø	1.15 m	2.29 m	3.44 m	

■ PACKAGE CONTENT

Aluminium Lamp Housing with 4-leaf Rotatable Barndoor
Set of 5 Par Lenses Ø112mm (4-3/8 in.) with Frames
Lens Case
GZY9.5 Lampholder
Igniter
Cable with Multipin Connector
Stirrup with Ø16mm (5/8 in.) Socket
Glass Becker

■ ACCESSORIES

400W/200W Electronic Ballast
400W/200W Electronic Ballast AC/DC
200W Electronic Ballast
200W Electronic Ballast AC/DC
Head to Ballast Cable 7m (23 ft.)
Head to Ballast Cable 15m (49 ft.)
4-leaf Rotatable Barndoor
Set of 5 Par Lenses Ø112mm (4-3/8 in.) with Frames :
Spot, Medium Flood, Wide Flood, Super Wide Flood, Frosted Super Flood
Lens Case
Glass Becker
Set of Softbox with T-ring