



L00400BX

## Boxer 400W

### ■ SPECIFICATIONS

Identity No.	L00400BX
Capacity	400W
Lamp Bulb Voltage	70V
Par Lens	Ø130mm (5-1/8 in.)
Weight (without barndoor)	1.3 kg
Lamp Type	HMI 400W SE 5600K
Lamp Holder	GZZ9.5
Stirrup	Ø16mm (5/8 in.) Socket
Class / IP Rating	1 / 20
Max. Surface Temp.	170 °C
Max. Ambient Temp.	45 °C
Min. Distance to Illuminated Object	3.0 m
Min. Distance to Flammable Object	0.5 m
Operating Range	45° - 0° - 45°

### ■ DIMENSIONS (mm)

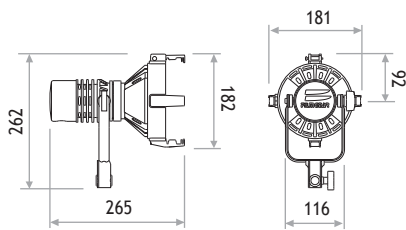

### ■ PHOTOMETRIC DATA

		Distance	3m	5m	7m
400W Spot (9°)	Lux		173271	62378	31825
	Beam Ø		0.47 m	0.79 m	1.10 m
Medium Flood (10° x 20°)	Lux		17058	6141	3133
	Beam Ø		0.52 x 1.06 m	0.87 x 1.76 m	1.22 x 2.47 m
Wide Flood (20° x 42°)	Lux		4982	1794	915
	Beam Ø		1.06 x 2.30 m	1.76 x 3.84 m	2.47 x 5.37 m
Super Wide Flood (40°)	Lux		2110	760	388
	Beam Ø		2.18 m	3.64 m	5.10 m
Frosted Super Flood (34°)	Lux		1616	582	297
	Beam Ø		1.83 m	3.06 m	4.28 m

### ■ PACKAGE CONTENT

Aluminium Lamp Housing with 4-leaf Rotatable Barndoor

Set of 5 Par Lenses Ø130mm (5-1/8 in.) with Frames

Lens Case

GZZ9.5 Lampholder

Igniter

Cable with Multipin Connector

Stirrup with Ø16mm (5/8 in.) Socket

Glass Becker

### ■ ACCESSORIES

400W/200W Electronic Ballast

400W/200W Electronic Ballast AC/DC

Head to Ballast Cable 7m (23 ft.)

Head to Ballast Cable 15m (49 ft.)

4-leaf Rotatable Barndoor

Set of 5 Par Lenses Ø130mm (5-1/8 in.) with Frames :

Spot, Medium Flood, Wide Flood, Super Wide Flood, Frosted Super Flood

Lens Case

Glass Becker

Set of Softbox with T-ring