



L01000TF

Tungsten Fresnel 1000W Studio

■ SPECIFICATIONS

Identity No.	L01000TF
Capacity	1,000W
Lamp Bulb Voltage	220V or 110V
Fresnel Lens	Ø175mm (6-7/8 in.)
Weight (without barndoor)	6.5 kg
Weight (with barndoor)	7.5 kg
Lamp Type	1000W SE 3200K
Lamp Holder	G22
Stirrup	Ø28mm (1-1/8 in.) Spigot
Class / IP Rating	1 / 23
Max. Surface Temp.	190 °C
Max. Ambient Temp.	45 °C
Min. Distance to Illuminated Object	1.5 m
Min. Distance to Flammable Object	0.5 m
Operating Range	45° - 0° - 45°

■ DIMENSIONS (mm)

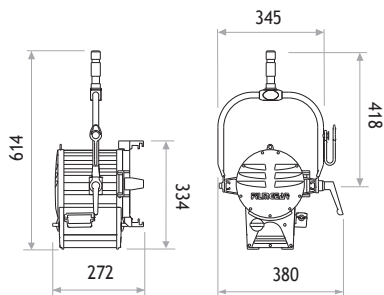

■ PHOTOMETRIC DATA

Distance	2m	6m	10m
Spot (8°)			
Lux	38708	4301	1548
Beam Ø	0.28 m	0.84 m	1.40 m
Flood (55°)			
Lux	4644	516	186
Beam Ø	2.08 m	6.24 m	10.41 m

■ PACKAGE CONTENT

- Aluminium Lamp Housing with 4-leaf Rotatable Barndoor with Safety Wire
- Ø175mm (6-7/8 in.) Fresnel Lens
- G22 Lampholder
- Stirrup with Ø28mm (1-1/8 in.) Spigot
- 3-core Cable 4m (13 ft.)
- On/Off Switch

■ ACCESSORIES

- 4-leaf Rotatable Barndoor
- Variable Snoot
- Filter Frame
- Set of 4 Scrims Ø229mm (9 in.) :
 - Full Single Scrim
 - Full Double Scrim
 - Half Single Scrim
 - Half Double Scrim
- Carrying Bag for Scrim Set
- Safety Wire